

# 16000 系列

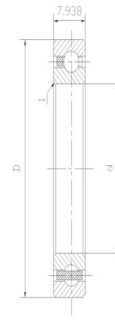

## 尺寸

基本额定载  
荷(N)

重量

select Inquiry 型号

|       |    |        | d(mm) | d(inch) | D(mm) | D(inch) | B(mm) | B(inch) | r min(mm) | r min(inch) | 动态(Cr) | 静态(Cor) | 重量(kg) |
|-------|----|--------|-------|---------|-------|---------|-------|---------|-----------|-------------|--------|---------|--------|
| 16100 | 10 | 0.3937 | 28    | 1.1024  | 8     | 0.3150  | 0.3   | 0.0118  | 5110      | 2380        | 0.0220 |         |        |
| 16101 | 12 | 0.4724 | 30    | 1.1811  | 8     | 0.3150  | 0.3   | 0.0118  | 5110      | 2380        | 0.0230 |         |        |
| 16001 | 12 | 0.4724 | 28    | 1.1024  | 7     | 0.2756  | 0.3   | 0.0118  | 4320      | 2250        | 0.0240 |         |        |
| 16002 | 15 | 0.5906 | 32    | 1.2598  | 8     | 0.3150  | 0.3   | 0.0118  | 5590      | 2840        | 0.0250 |         |        |
| 16003 | 17 | 0.6693 | 35    | 1.3780  | 8     | 0.3150  | 0.3   | 0.0118  | 6000      | 3250        | 0.0320 |         |        |
| 16004 | 20 | 0.7874 | 42    | 1.6535  | 8     | 0.3150  | 0.3   | 0.0118  | 6340      | 3790        | 0.0500 |         |        |
| 16005 | 25 | 0.9843 | 47    | 1.8504  | 8     | 0.3150  | 0.3   | 0.0118  | 6940      | 4600        | 0.0600 |         |        |
| 16006 | 30 | 1.1811 | 55    | 2.1654  | 9     | 0.3543  | 0.3   | 0.0118  | 9950      | 6530        | 0.0850 |         |        |
| 16007 | 35 | 1.3780 | 62    | 2.4409  | 9     | 0.3543  | 0.3   | 0.0118  | 10820     | 7830        | 0.1100 |         |        |
| 16008 | 40 | 1.5748 | 68    | 2.6772  | 9     | 0.3543  | 0.3   | 0.0118  | 11590     | 9130        | 0.1250 |         |        |
| 16009 | 45 | 1.7717 | 75    | 2.9528  | 10    | 0.3937  | 0.6   | 0.0236  | 11830     | 9880        | 0.1700 |         |        |
| 16010 | 50 | 1.9685 | 80    | 3.1496  | 10    | 0.3937  | 0.6   | 0.0236  | 12510     | 11100       | 0.1800 |         |        |
| 16011 | 55 | 2.1654 | 90    | 3.5433  | 11    | 0.4331  | 0.6   | 0.0236  | 19300     | 16300       | 0.2600 |         |        |
| 16012 | 60 | 2.3622 | 95    | 3.7402  | 11    | 0.4331  | 0.6   | 0.0236  | 20000     | 17500       | 0.2800 |         |        |
| 16013 | 65 | 2.5591 | 100   | 3.9370  | 11    | 0.4331  | 0.6   | 0.0236  | 21200     | 17800       | 0.3000 |         |        |
| 16014 | 70 | 2.7559 | 110   | 4.3307  | 13    | 0.5118  | 0.6   | 0.0236  | 26800     | 23600       | 0.433  |         |        |
| 16015 | 75 | 2.9528 | 115   | 4.5276  | 13    | 0.5118  | 0.6   | 0.0236  | 27600     | 25300       | 0.457  |         |        |